

# Spray Polyurethane Foam for agricultural applications

Polyurethane foam is a versatile, easy-to-use and economical option for roofing, walls and storage tank insulation in the agricultural building envelope market.

SPF offers a selection of fluid-applied systems and protective coating systems that are monolithic, easy to apply and have a proven performance record, even under extreme conditions.

Benefits include:

- Fluid, seamless application that fully adheres to the surface to reduce moisture penetration
- Thermal efficiency for reduced energy costs
- Insulation R value of 6 per inch – the best insulation available
- Increased cost-effectiveness and reduced life cycle costs
- Extended HVAC equipment life
- Reduced installation requirements – conforms to round tanks and irregular roof/wall surfaces more efficiently than traditional systems
- Reduced maintenance requirements
- Application without fasteners and thermal bridging

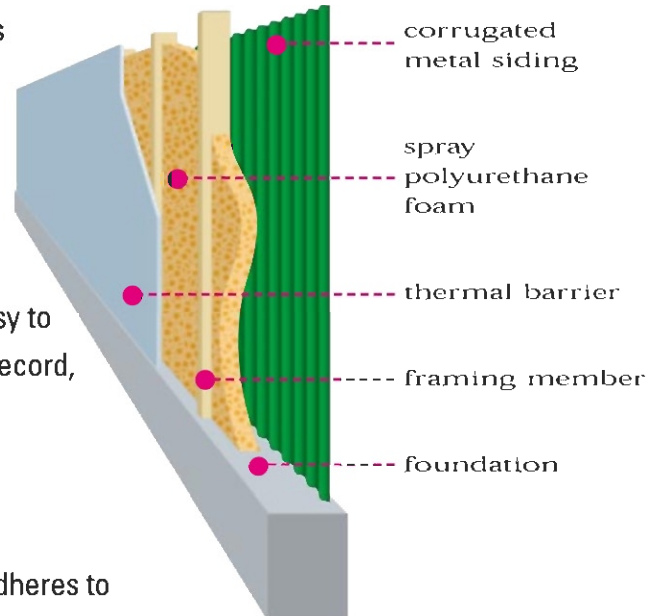

SPF has minimum environmental impact. Its use has been rated and certified by local code regulations, and is approved for use around foodstuffs and livestock.

Some of the agricultural applications for SPF include:

#### Roofing Retrofits

- Pre-engineered panels and irregular, corrugated metal roofs commonly found on agricultural buildings have an average lifespan of six to seven years, which can be extended with the use of SPF
- Without foam insulation, rubber grommets around screws that fasten the roof to the building begin to deteriorate, causing moisture to invade, resulting in corrosion, rusting and leaks

#### Storage Tanks

- Many agricultural chemicals, such as anhydrous ammonia (fertilizer) need to be stored in at temperatures as low as -21°F, necessitating high-level insulation
- Traditional systems such as board stock glued in place present difficult and costly installation

#### Other Buildings

- Fruit, vegetable storage buildings
- Coolers and freezers
- Silos
- Roof/wall application
- Building envelope